

### Features

- Modular 2 speed flow control valves allow setting of the flow by means of a manual adjustable flow control. Full flow can be achieved by energizing the solenoid valve to bypass the flow control valve.
- Used when 2 speeds of movement are required.
- Meter-out flow from actuator as standard.
- Modular valves are flexible, easy to replace and maintain without the cost of custom manifolds.



### Ordering Details

V	Valve							
M	Modular							
F2S-	Type: Flow control 2 speed							
6-	Mounting Size: _____	<table border="1"> <thead> <tr> <th>Code</th> <th>Size</th> </tr> </thead> <tbody> <tr> <td>6</td> <td>NG6 (D03)</td> </tr> <tr> <td>10</td> <td>NG10 (D05)</td> </tr> </tbody> </table>	Code	Size	6	NG6 (D03)	10	NG10 (D05)
Code	Size							
6	NG6 (D03)							
10	NG10 (D05)							
A-	Circuit Function: _____							
H/	Flow Control Adjustment: H = Allen Wrench, R=Rotary Knob							
12-	Solenoid Voltage: 12=12VDC, 24=24VDC, 110=110VAC							
1	Series							

Code	Symbol
A	
B	

Example Part Number: VMF2S-6-A-H/12-1

### Technical data

Size	Max. Flow lpm (gpm)	Max. Pressure, bar (psi)	Weight Kg (lbs.)	Fluid Recommendation	Working temperature	Fluid Cleanliness
VMF2S-6	20 (5.3)	250 (3625)	1.5 (3.3)	Mineral Based, viscosity 10- 800mm <sup>2</sup> /s	-20 to +80°C (-4 to +176°F)	According to ISO 04406 Class 20/18/15
VMF2S-10	45 (11.8)	250 (3625)	2.8 (6.2)			

**Dimensional Data, VMF (Dimensions in mm)**

**VMF2S-6-A**

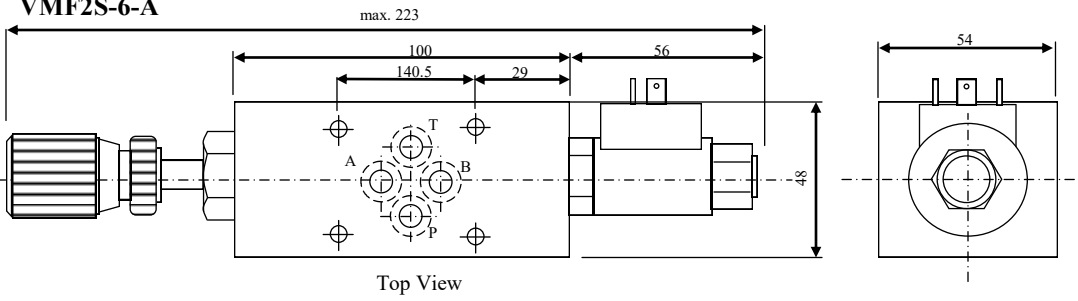

NG6/D03 Mounting Dimensions of mating surface

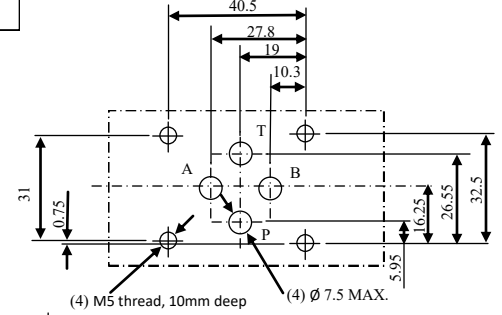

**VMF2S-6-B**

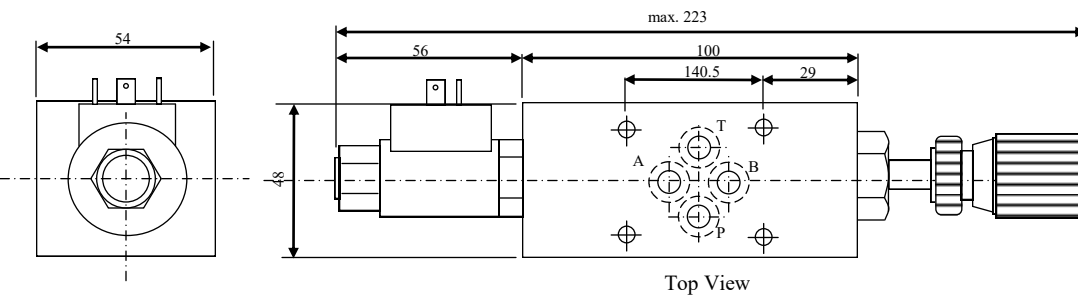

**VMF2S-10-A**

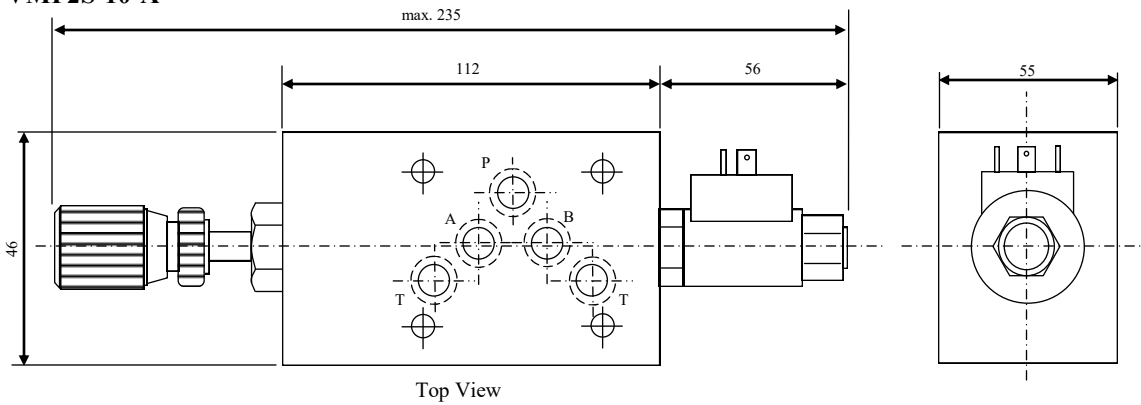

NG10/D05 Mounting Dimensions of mating surface

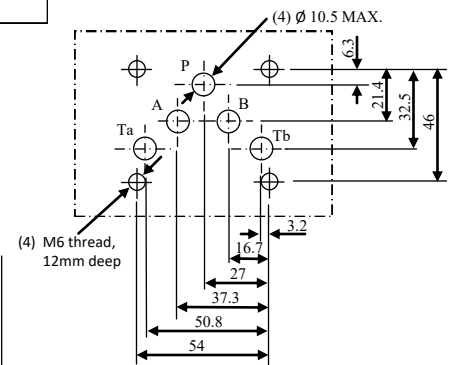

**VMF2S-10-B**

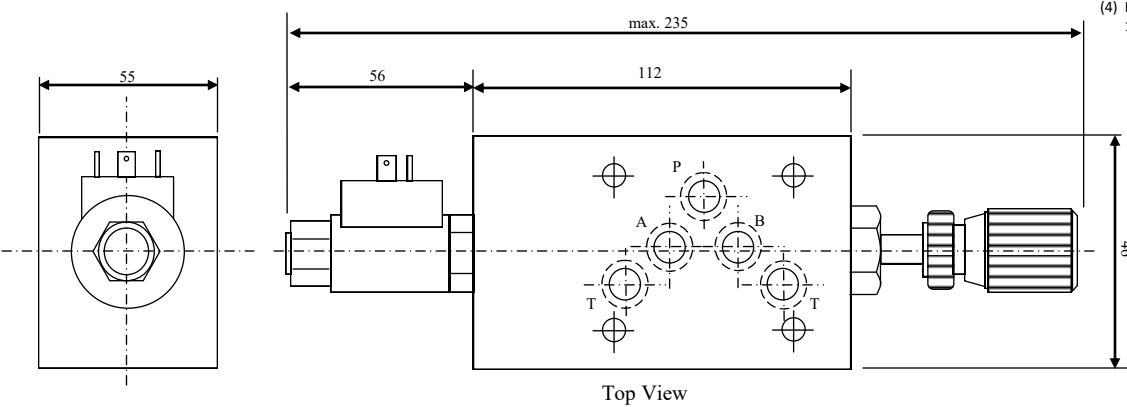

Note : Mating Surface Requirement

